

Note that all unique customer requirements (i.e tolerance) need to be verified thru Alfa Laval.

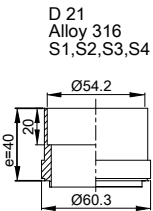

D 21  
Alloy 316  
S1,S2,S3,S4

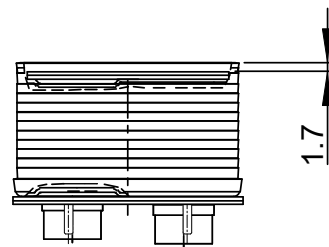
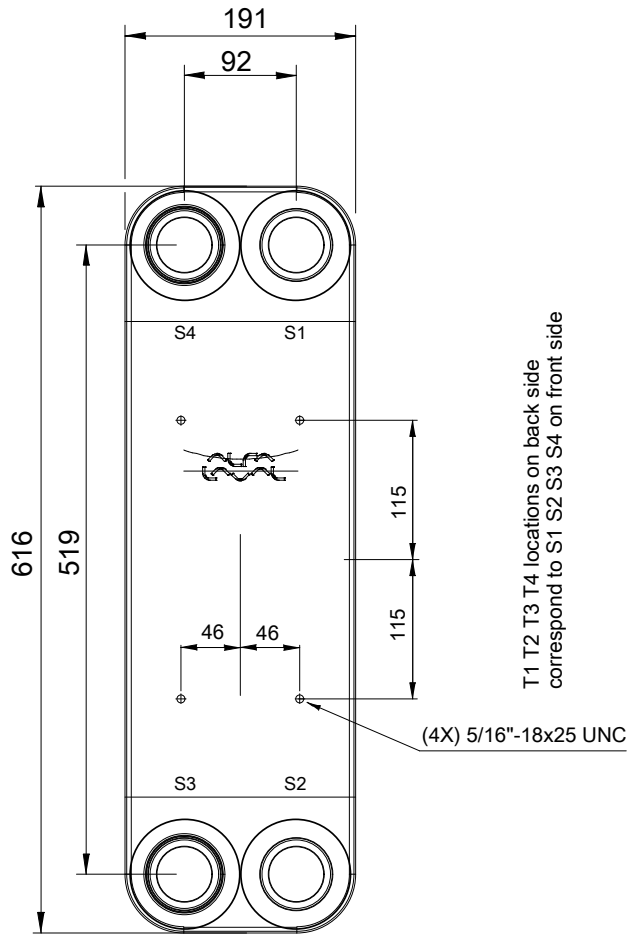
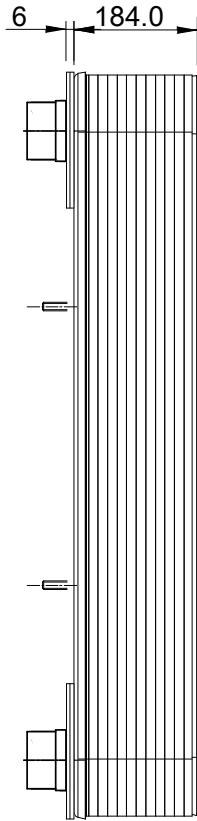

HEATING SURFACE  
NETWEIGHT 38.7 kg  
OPERATING WEIGHT  
PLATE MATERIAL Alloy 316  
PLATE GROUPING 1\*32H/1\*33H

T1 T2 T3 T4 locations on back side correspond to S1 S2 S3 S4 on front side

(4X) 5/16"-18x25 UNC

ALL DIMENSIONS IN MILLIMETERS

SIDE	MEDIA	INLET	TEMP.	OUTLET	TEMP.	FLOW RATE	PRESSURE DROP	LIQUID VOL.
1								6.72 dm <sup>3</sup>
2								6.93 dm <sup>3</sup>

PRESSURE VESSEL APPROVAL

UL/CRN

CBH110-66H S89 (3287133778)

www.alfalaval.com

CUSTOMER NAME / REF. NO.

COMPANY / REF.

TOTAL LENGTH 224.0 mm  
TOTAL WIDTH 191.0 mm  
TOTAL HEIGHT 616.0 mm

8/24/2017  
REV 0